

INSTALLATION PROCEDURE - SEAL KIT 7195238, 2" ECO FLOW PACK VALVE

Remove Old Seals And Rings

1. Advance the valve to the Backwash position with the CHARGE button, place the softener in BYPASS and unplug the transformer.
2. Remove 2" inlet, outlet, and drain nipples by unsnapping their clamps (Fig. 1).
3. Remove aspirator assembly by lifting out the U-pins that hold it in place (Fig. 1).
4. Remove the valve assembly from the tank by unsnapping the clamps holding it on the tank adaptor (Fig 1).

FIGURE 1

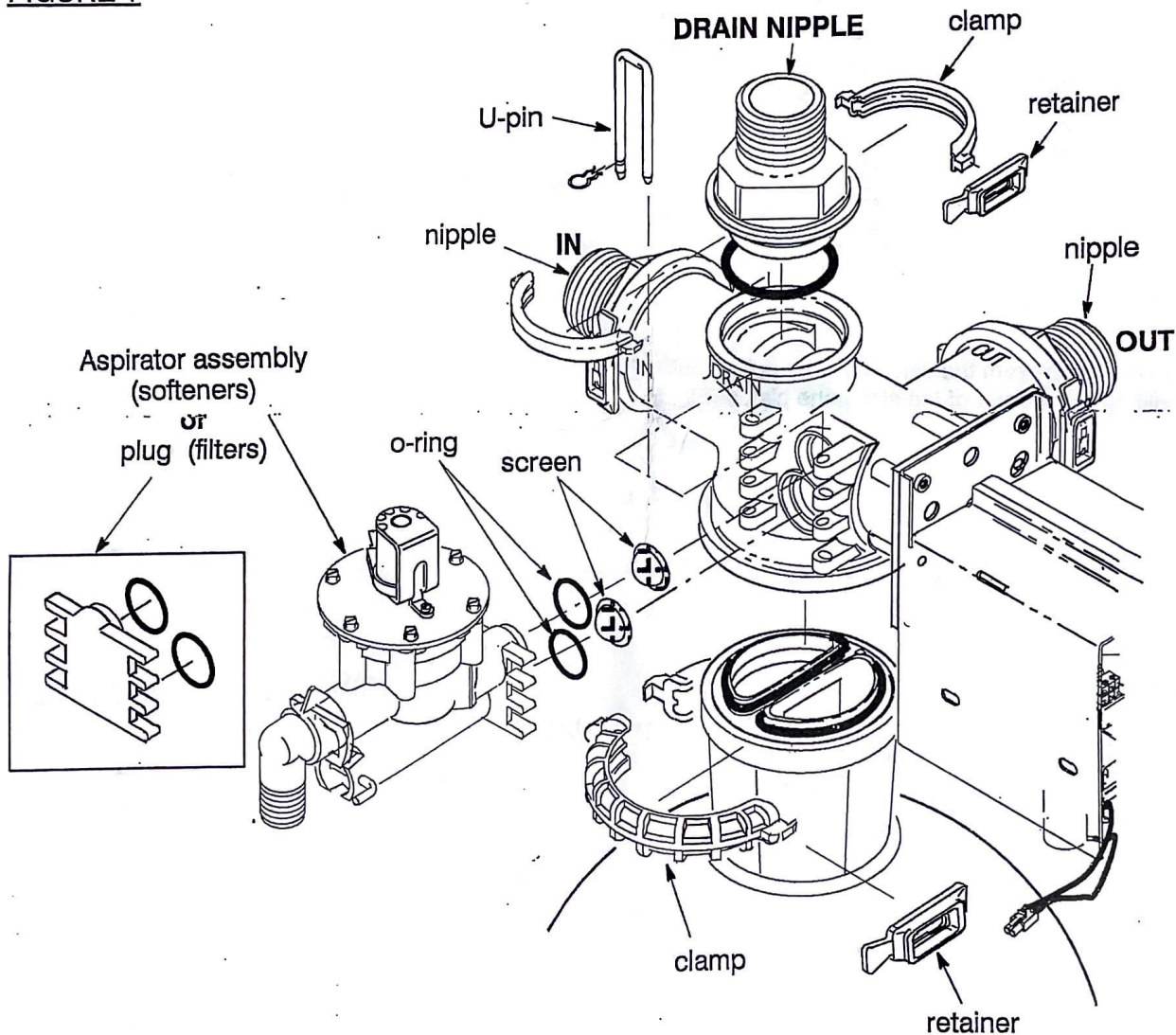

5. Unscrew the 4 bolts securing the inner bracket; slide the inner bracket assembly away from the outer bracket (Fig. 2).
6. Unscrew the 4 bolts holding the outer bracket to the valve (Fig. 2).
7. Unscrew the 6 screws holding the mounting bracket to the valve body (Fig. 2).

FIGURE 2

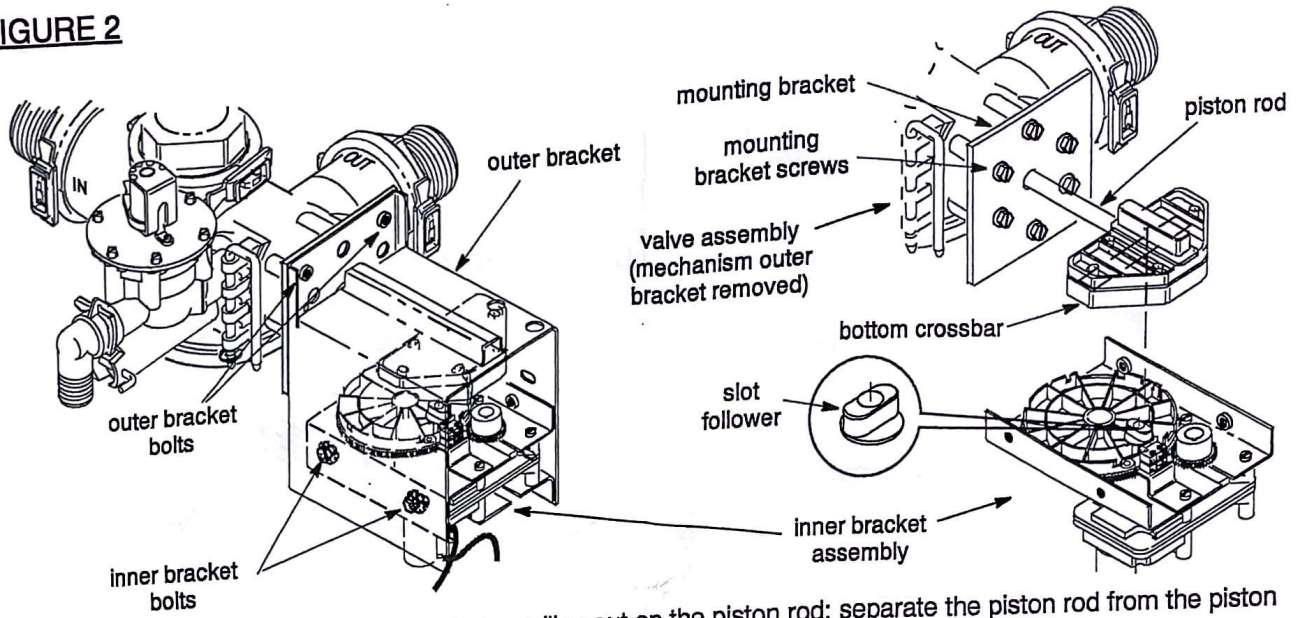

8. Remove piston from the valve body by pulling out on the piston rod; separate the piston rod from the piston by sliding the rod out of the slot in the piston (Fig. 3).

FIGURE 3

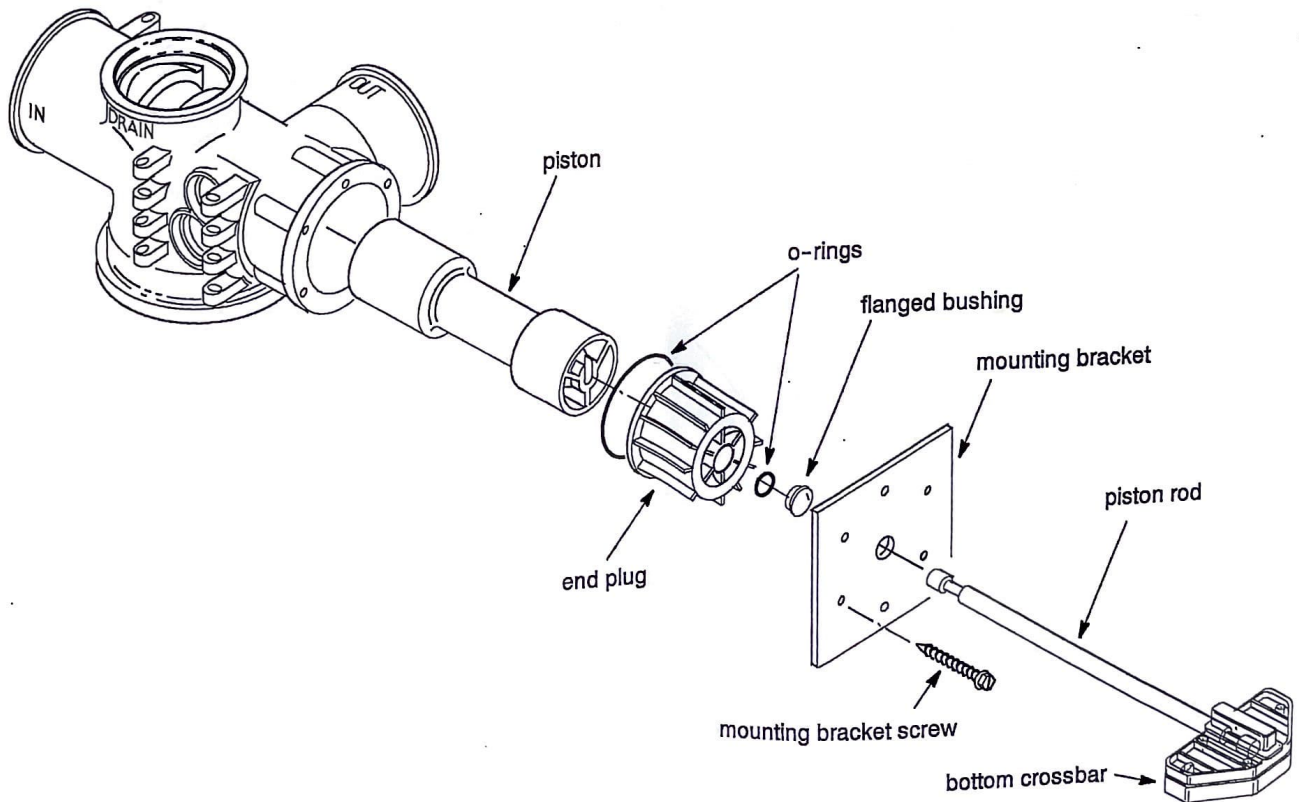

9. Put the valve on a table with inlet facing upward. Punch out lantern rings one-at-a-time. Start with the lantern ring closest to the motor-end of the valve and work up. Each lantern ring will carry out a quad-ring and an o-ring seal.

Hint:

- a. Place the blunt blade of a long screwdriver against an opening in a lantern ring and tap the screwdriver just enough to loosen the ring (Fig. 4). Use a screwdriver without sharp edges.
- b. Once a lantern ring is loose, it can be easily pulled out of the valve body by turning the valve motor-side up and sliding the lantern ring out with fingers.
- c. Return the valve to the inlet end up and punch the next lantern ring.

FIGURE 4

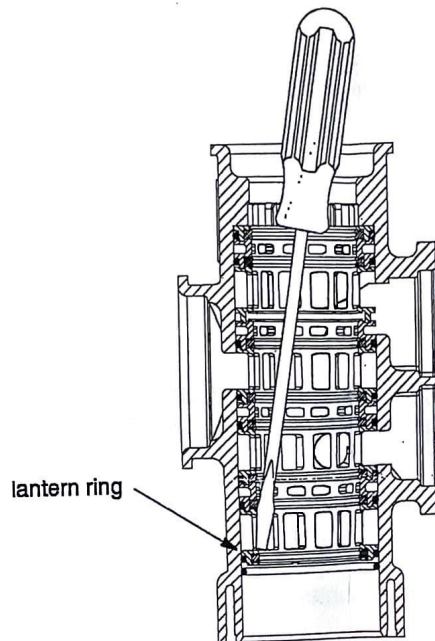

Replace New Seals And Rings

1. Insert new lantern rings, quad-ring seals and o-rings in the valve body from the motor end either one-at-a-time or as an entire string. Refer to Fig.5 to assure that they are inserted in the correct order and right-side up.
 - a. To insert the rings and seals in one step:
 - i. Lubricate the seals well and stack up the entire string of rings and seals with the ring base on the top.
 - ii. Center the valve housing over the stack with the motor-end facing down.
 - iii. Push firmly on the valve housing to slide it over the stack of rings and seals. Be careful: push straight or the quad-rings catch on the edges of openings in the valve body.
 - b. As an alternative, each lantern ring can be individually positioned with its quad-ring and o-ring from the motor end of the valve housing. The o-rings may have to be "helped" past the edges of openings in the valve body by pushing them into place with the blunt end of a screwdriver.

FIGURE 5

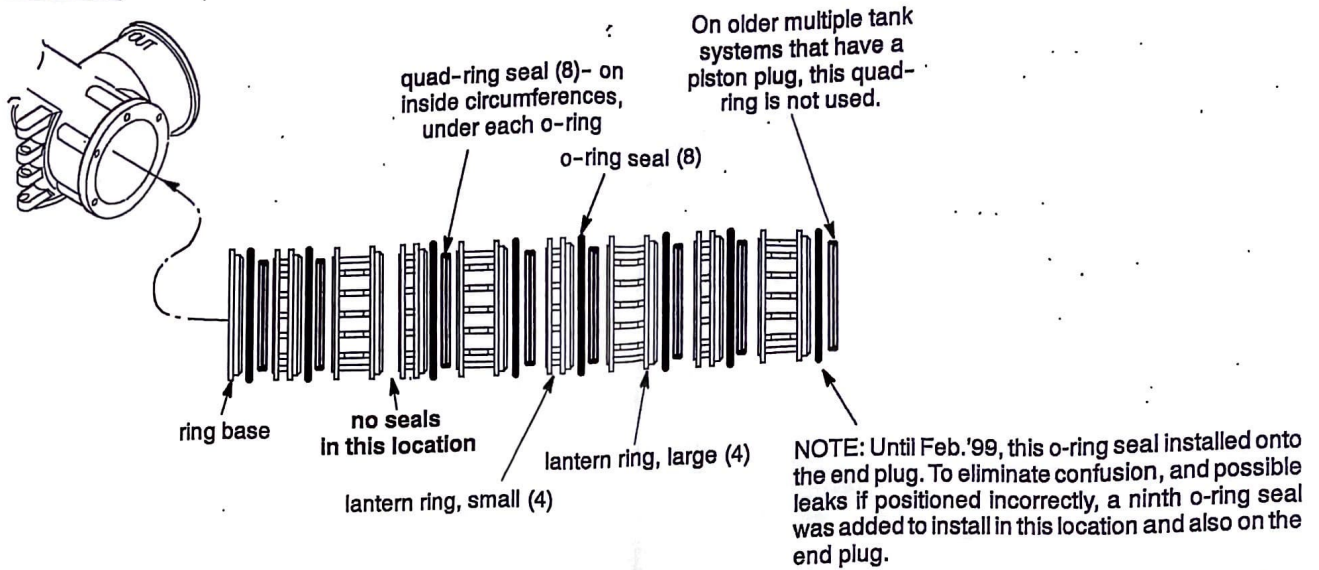

2. Push the piston into the valve through the motor end. The quad-rings will catch on the end of the piston if the piston isn't exactly centered.
3. Once the piston has started through the rings and seals, insert the piston rod in the motor end of the piston. Continue moving the piston through the rings by pushing on the crossbar attached to the piston rod.
4. Guide the end plug (which slides on the piston rod) and its o-ring into the valve body and push until the end plug hits against the outer quad-ring. The end plug will remain about 1/8 in. above the lip of the valve body until the quad-rings are compressed.
5. Tighten the mounting bracket in place with the 6 screws.

Hint:

Since this procedure compresses the quad-rings, tighten the screws in a crossing pattern to draw the bracket down straight against the valve body.

6. Move the piston in or out by pushing or pulling on the crossbar (or the piston) until the back end of the piston lines up with the scribe mark in the lower port of up-flow aspirator location. This assumes that the piston was left in the BW position when the transformer was unplugged. (See Fig. 6).

FIGURE 6

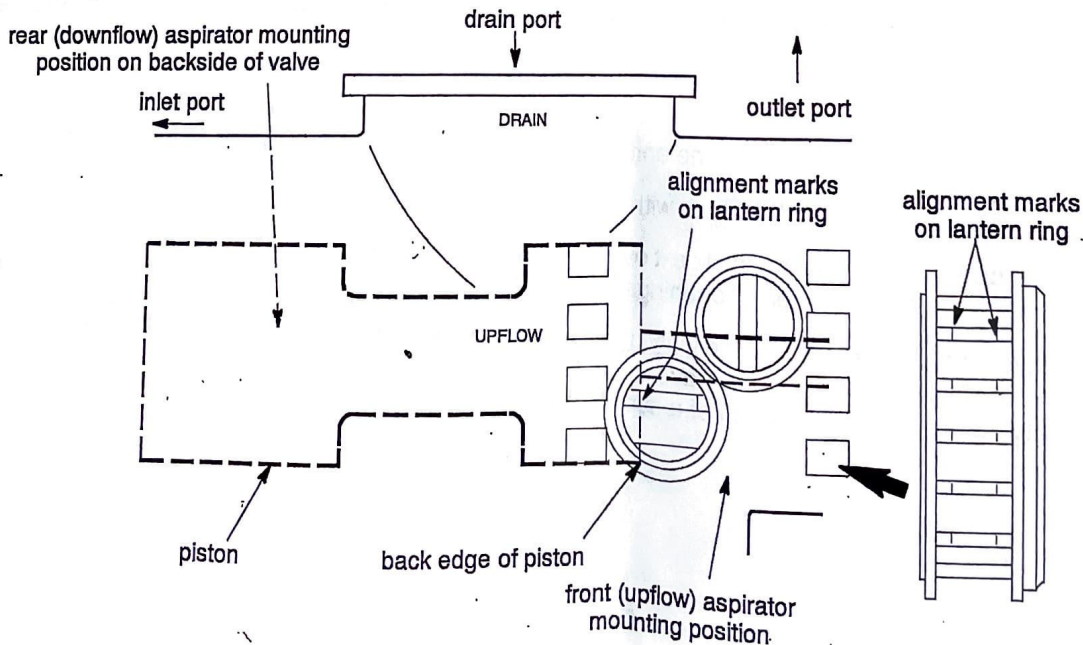

7. Secure the outer bracket to the mounting bracket with 4 bolts.
8. Slide the inner bracket with drive components into the outer bracket. Guide the oblong slot follower into the slot in the cross bar on the piston rod (Fig. 3). Check to see that the back end of the piston is still lined up with the scribe mark in the aspirator port.
9. Re-insert the 4 bolts that secure the inner bracket to the outer bracket.
10. Re-install valve assembly on tank adaptor.
11. Re-insert the aspirator.